

TOWER PLACE FESTIVAL

8700 PINEVILLE-MATTHEWS ROAD | CHARLOTTE, NC 28226



CONTACT

Spencer Brown | 704.644.4582
sbrown@providencegroup.com

CONTACT

Thurman Brooks | 704.644.4585
tbrooks@providencegroup.com

[CLICK FOR VIDEO TOUR](#)

TOWER PLACE FESTIVAL

8700 PINEVILLE-MATTHEWS ROAD | CHARLOTTE, NC 28226

PROPERTY INFORMATION

SHOPPING CENTER GLA: _____ 114,876 SF
 AVAILABLE SPACE: _____ 1,600; 3,500 SF; &
 2,310 SF (2nd Gen Restaurant)
 LEASE RATE: _____ Please Call
 TICAM: _____ \$5.60 / SF

PROPERTY HIGHLIGHTS

- Well located on reputable Highway 51/Pineville retail corridor
- Very strong daytime population in close proximity
- Great visibility and traffic volume on Pineville-Matthews Road (Highway 51)
- Strong regional pull with close access to Carolina Place Mall and I-485

DEMOGRAPHICS (2023)	1 MILE	3 MILE	5 MILE
POPULATION	10,658	69,600	192,376
AVERAGE HH INCOME	\$71,306	\$118,846	\$124,193
MEDIAN HH INCOME	\$70,298	\$86,301	\$95,201
BUSINESS ESTABLISHMENTS	1,099	4,669	11,141
DAYTIME EMPLOYMENT	11,861	62,448	137,109

				
37,398	15,374	\$85,105	1,156	49.9%
POPULATION*	ESTIMATED # HOUSEHOLDS*	AVERAGE HH INCOME*	TOTAL # BUSINESSES*	BACHELOR/ GRAD DEGREE*

* 3 MILE RADIUS

53,000

TRAFFIC COUNTS
ON PINEVILLE-MATTHEWS RD



\$2,424

MONTHLY RETAIL
EXPENDITURE*



© 2023 The Providence Group. All rights reserved. The information above has been obtained by sources deemed reliable. While we do not doubt its accuracy, we have not verified it and make no guarantee, warranty, or representation of it. It is your responsibility to independently confirm its accuracy and completeness. You and your advisors should conduct a careful, independent investigation of the property to determine to your satisfaction the suitability of the property for your needs.



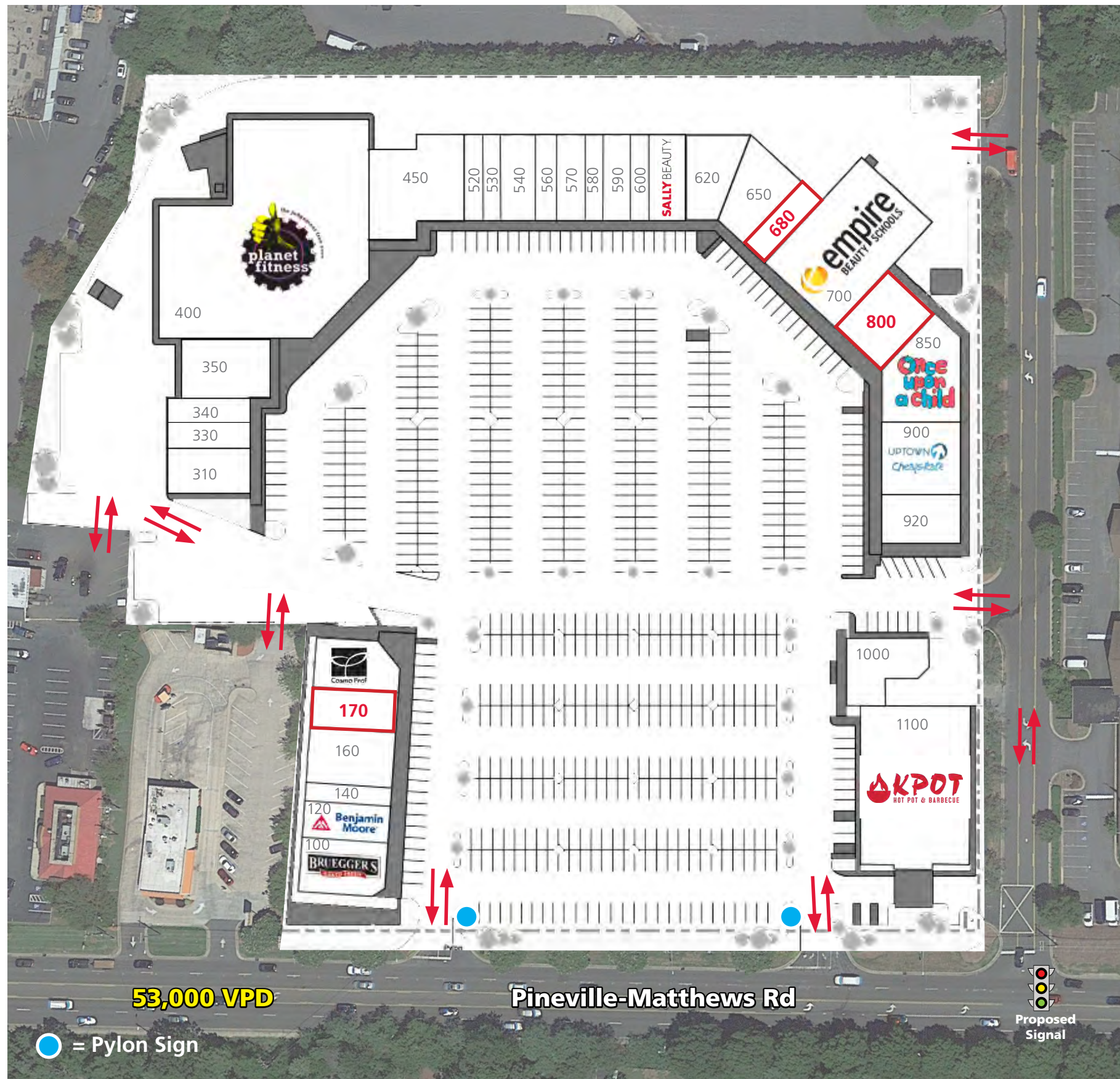

#	TENANT	SF	#	TENANT	SF
100	Brueggers Bagels	2,959	570	Hello Chicken	1,610
120	Benjamin Moore	2,100	580	Independence Coin	1,050
140	I Extend Beauty	1,050	590	Sneaker 1	1,540
160	Thai House	3,220	600	Vina Alterations	1,120
170	Available 2nd Gen Restaurant	2,310	610	Sally Beauty	1,716
200	CosmoProf	2,670	620	Jets Pizza	2,484
310	Tavern 51	2,600	650	Burn Boot Camp	3,750
330	Pineville Humidor & Tobacco	1,500	680	Available	1,600
340	Green Life Remedies	1,500	700	Empire Beauty School	9,600
350	Our Health	3,496	800	Available	3,500
400	Planet Fitness	25,637	850	Once Upon a Child	4,891
450	Stephanie's Mattress	5,634	900	Uptown Cheapskate	4,200
520	Cherry Ice Cream	1,050	920	Brazile and Moorehead Dentistry	2,800
530	Nails First	1,050	1000	Las Americas Restaurant	2,871
540	Compleat Rehab	2,000	1100	KPOT Korean BBQ	12,108
560	Mosaic Hair Salon	1,260			



© 2023 The Providence Group. All rights reserved. The information above has been obtained by sources deemed reliable. While we do not doubt its accuracy, we have not verified it and make no guarantee, warranty, or representation of it. It is your responsibility to independently confirm its accuracy and completeness. You and your advisors should conduct a careful, independent investigation of the property to determine to your satisfaction the suitability of the property for your needs.



Carolina Pavilion

TARGET, VALUE CITY Furniture, ROSS DRESS FOR LESS, BIG LOTS!, AMC THEATRES, OLD NAVY, PETSMART, buybuy BABY, NORDSTROM, RACK, DSW, DOLLAR TREE, WORLD MARKET

McMullen Creek

Walmart Neighborhood Market, Burlington coat Factory, DOLLAR TREE, STAPLES

Atrium Health

Park 51 Shops

ALDI

SITE

planet fitness

Johnston Road Plaza

FOOD LION

LOWE'S

Centrum S/C

THE HOME DEPOT, Super Mart, BEST BUY, Gabes

Office DEPOT

Carolina Place Mall

belk, JCPenney, DICK'S SPORTING GOODS, Dillard's, BARNES & NOBLE

Carmel Commons

Party City, PET SUPPLIES PLUS, CROCK POT CHEESE'S, CHILDREN'S PLACE

Pineville Towne Market

FOOD LION

SAM'S CLUB, B.Y.S., ASHLEY FURNITURE INDUSTRIES, INC., HAVERTYS, ROOMS TO GO, Bassett, at home, GOODS, ETHAN ALLEN, LEE LIGHTING

CLICK FOR VIDEO TOUR

CONTACT

Thurman Brooks | 704.644.4585
tbrooks@providencegroup.com

Spencer Brown | 704.644.4582
sbrown@providencegroup.com